



## DM4 Stelo

Stylistically, this bollard luminaire for outdoor use is an excellent match with the wall-mounted DM4 luminaires. The DM4 Stelo bollard luminaire reflects light in four directions. Available with an integrated LED and an E27 base. High-quality surface treatment: the aluminium housing is coated with polyester paint that is resistant to corrosion and UV radiation, the screws are made of stainless steel. Installation with a separate mounting base (ground mounting tube MTS-2N 4146704).



- Aluminium housing and frosted glass diffuser (GLFR).
- Anthracite, silver, black and white.
- Protection class I.
- Screw couplers, 3 x 2.5 mm<sup>2</sup>, one cable inlet.
- Linkable using separate mini junction box 1602606.
- Fixed LED: 18 W / 800 lm
- Fixed LED colour temperatures: 3,000 K and 4,000 K. CRI > 80 / Ra > 80.
- In E27 models LED lamp max. 11 W, not included.
- Recommended lamps: Airam Frost LED lamps.
- MacAdam 3 SDCM.
- IP65.
- IK05.
- On/off.
- Ambient temperature range -25 ... 25 °C, in line with the recommendations for the lamp on E27 base models.
- Rated lifetime L70 100,000 h (Ta 25 °C).
- Power source lifespan 100,000 h.
- AN = anthracite, SI = silver, BK = black, WH = white, GL = glass, FR = frosted diffuser.
- 300 and 500 mm-high models available on a project-specific basis. A cover sheet that can be used to cover one or more of the luminaire's four openings is available as an accessory. A root mounting kit is also an available accessory.

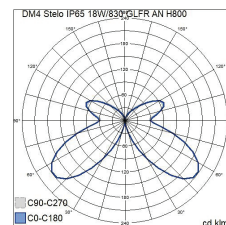
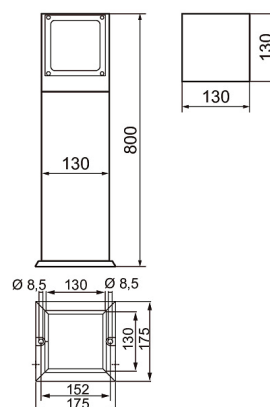

### By order

#### DM4 Stelo 830

NO.	CODE	W	LM
4509934	B5DMCH IP65 IK05 18W/830 GLFR AN H800	18	800
4509933	B5DMCG IP65 IK05 18W/830 GLFR SI H800	18	800
4509931	B5DMCF IP65 IK05 18W/830 GLFR BK H800	18	800
4509929	B5DMCE IP65 IK05 18W/830 GLFR WH H800	18	800

#### DM4 Stelo 840

NO.	CODE	W	LM
4509938	B5DMCL IP65 IK05 18W/840 GLFR AN H800	18	800
4509937	B5DMCK IP65 IK05 18W/840 GLFR SI H800	18	800
4509936	B5DMCJ IP65 IK05 18W/840 GLFR BK H800	18	800
4509935	B5DMCI IP65 IK05 18W/840 GLFR WH H800	18	800

#### DM4 Stelo E27

NO.	CODE
4509942	B5DMCP IP65 IK05 E27 GLFR AN H800
4509941	B5DMCO IP65 IK05 E27 GLFR SI H800
4509940	B5DMCN IP65 IK05 E27 GLFR BK H800
4509939	B5DMCM IP65 IK05 E27 GLFR WH H800